

SHIMANO®

1987 REPAIR MANUAL

Shimano American Corporation, One Shimano Dr.
Irvine, CA 92718

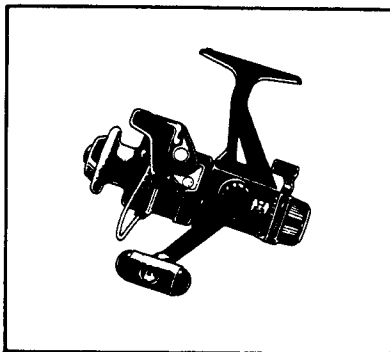

TO ORDER:
This reel belongs to the "Rear Drag" series.
Please order parts using the abbreviation
"RD" and the part number.

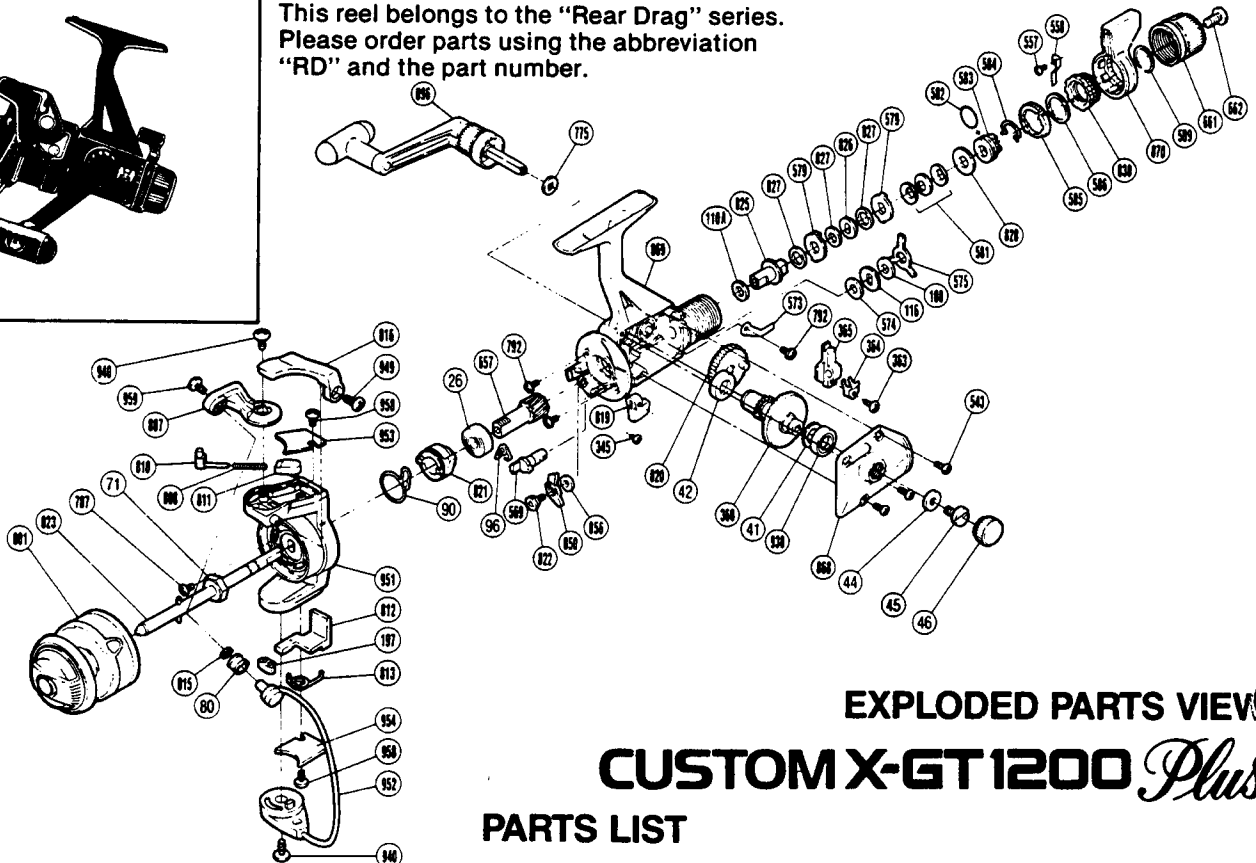

EXPLODED PARTS VIEW

CUSTOM X-GT1200 *Plus*

PARTS LIST

PART # DESCRIPTION

- 26. Ball Bearing
- 41. Drive Gear Washer
- 42. Bushing
- 44. Handle Lock Washer
- 45. Handle Lock Screw (Originally 796)
- 46. Handle Screw Cap
- 71. Rotor Nut
- 80. Line Roller
- 90. Anti-Reverse Pawl Spring
- 96. Anti-Reverse Cam Spring
- 108. Drag Washer "C₁"
- 110A. Drag Washer "D₂"
- 116. Click Gear
- 197. Bail Trip Slide Cam
- 345. Anti-Reverse Lever Screw
- 360. Drive Gear
- 363. Slider Retainer Screw
- 364. Oscillating Slider Retainer
- 365. Oscillating Slider
- 543. Side Cover Screw
- 557. Fightin' Lever Click Screw
- 558. Fightin' Lever Click
- 569. Anti-Reverse Cam
- 573. Drag Click

PART # DESCRIPTION

- 574. Drag Washer "C₂"
- 575. Eared Washer "BF"
- 579. Eared Washer "B"
- 581. Coned Disk Springs
- 582. "O" Ring
- 583. Pressure Screw
- 584. Hold Click Spring
- 585. Lever Click Gear
- 586. Fightin' Pressure Screw Washer
- 589. Lever Hold Spring
- 657. Pinion Gear
- 661. Drag Programmer
- 662. Drag Programmer Screw
- 775. Handle Lock Spacer
- 787. Nut Lock Screw
- 792. Multi Purpose Screw
- 801. Spool Assembly' (Universal)
- 807. Bail Arm
- 808. Bail Spring
- 810. Bail Spring Guide A
- 811. Bail Spring Guide B
- 812. Bail Trip Lever
- 813. Lever Spring
- 815. Line Roller Washer
- 816. Quick-Fire II Trigger

PART # DESCRIPTION

- 819. Anti-Reverse Lever
- 820. Oscillating Gear
- 821. Anti-Reverse Ratchet
- 822. Anti-Reverse Pawl Screw
- 823. Main Shaft
- 825. Drag Shaft
- 826. Key Washer "A"
- 827. Drag Washer "H,"
- 828. Drag Spring Washer "A"
- 830. Fightin' Pressure Screw
- 850. Anti-Reverse Pawl
- 856. Anti-Reverse Pawl Spacer
- 868. Side Cover
- 869. Body
- 870. Fightin' Drag Lever
- 896. Handle Assembly
- 930. Ball Bearing
- 940. Bail Trip Cam Screw
- 949. Trigger Screw
- 951. Rotor
- 952. Bail Assembly
- 953. Bail Spring Cover
- 954. Bail Trip Cover
- 958. Bail Trip Cover Screw
- 959. Line Roller Screw